

Installation of DAMPA Sport

The strong construction of DAMPA Sport is ideally suited for ceiling and wall surfaces in areas of high activity where the risk of damage or impact is considerable, for example sports halls, subways, corridors and the like.

- 1 All carrier and hanger centres are maximum distances.

Max. distance	Steel
A	300 mm
B	1500 mm
C	2000 mm

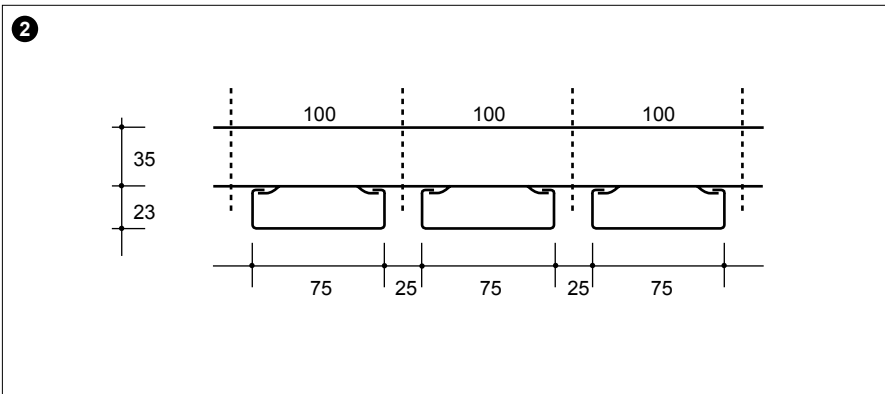

- 2 A 100 mm module is obtained with 75 mm units and an open gap of 25 mm.

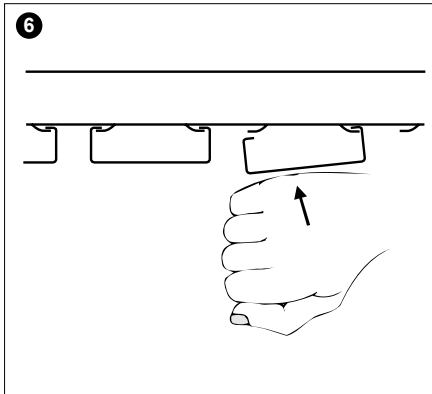
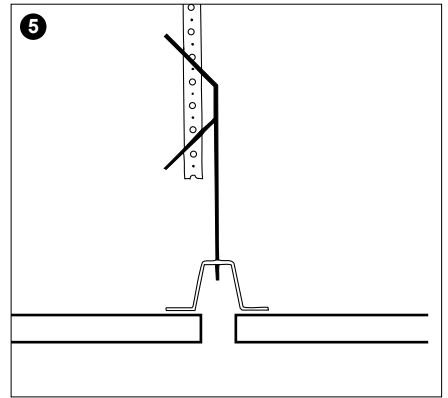
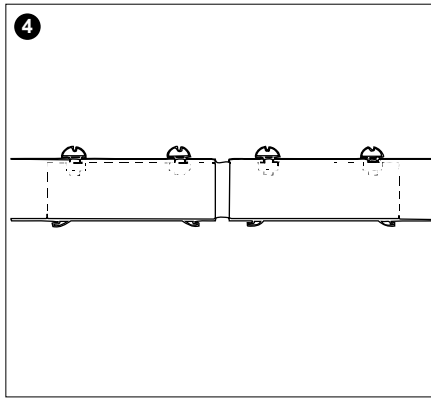
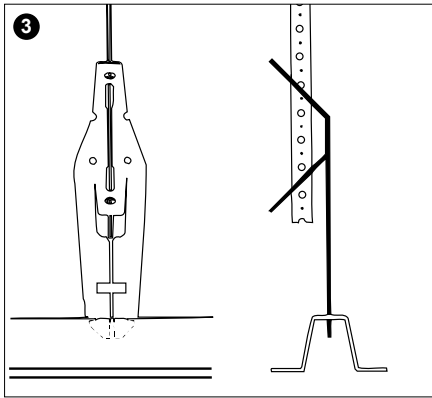

3 Adjustment Clip No. 5 with Hanger No. 5 is located into the slots provided in the modular carrier.

The pull-out force of the hanger must be at least 2.5 times the hanger load.

4 Carriers are joined with Carrier Splices and four nuts and screws. Before tightening, the correct module is achieved by pulling the carriers apart until the screws locate at the ends of the slots.

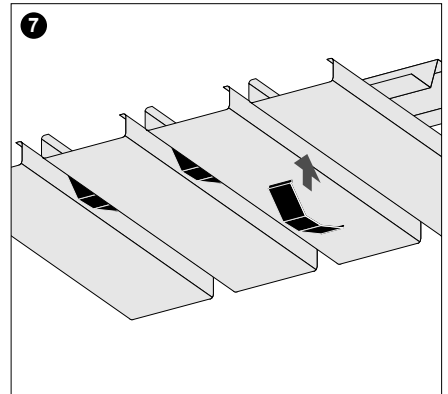

5 When installing ceilings requiring panel lengths greater than 6 m, jointing can be achieved by forming a gap of 10 to 25 mm between the ends of the panels immediately under a carrier.

To prevent movement of the ceiling, modular carriers are braced against the wall. The first and last modular carriers should be braced at right angles approx. every 2000 mm. The exposed ends of the bracing should be painted black.

6 The panels are installed into the carrier and held in position with the nearest flange located in the clips. The opposite flange is sprung into the clips by lightly striking the panels with the side of the fist.

7 To secure the DAMPA Sport system, locking clips should be located over the exposed carrier flanges in the gaps between ceiling units.

The locking clips are easily clipped in.